



Overview

Solar Roof is a fully integrated roof system comprised of matching solar tiles and non-solar tiles. The layout provided only details the active solar tile positions. Solar tile positions are approximate and may change depending on roof conditions and electrical requirements

Customer

XYYYYYYYYY

Solar Roof

Solar System Size: 15.2 kW
Est. Annual Energy Produced: 21568 kWh/yr
Building(s) with Solar Roof: Main home only

If you have questions or concerns regarding your layout, please contact a Tesla Advisor at (877)701-7652

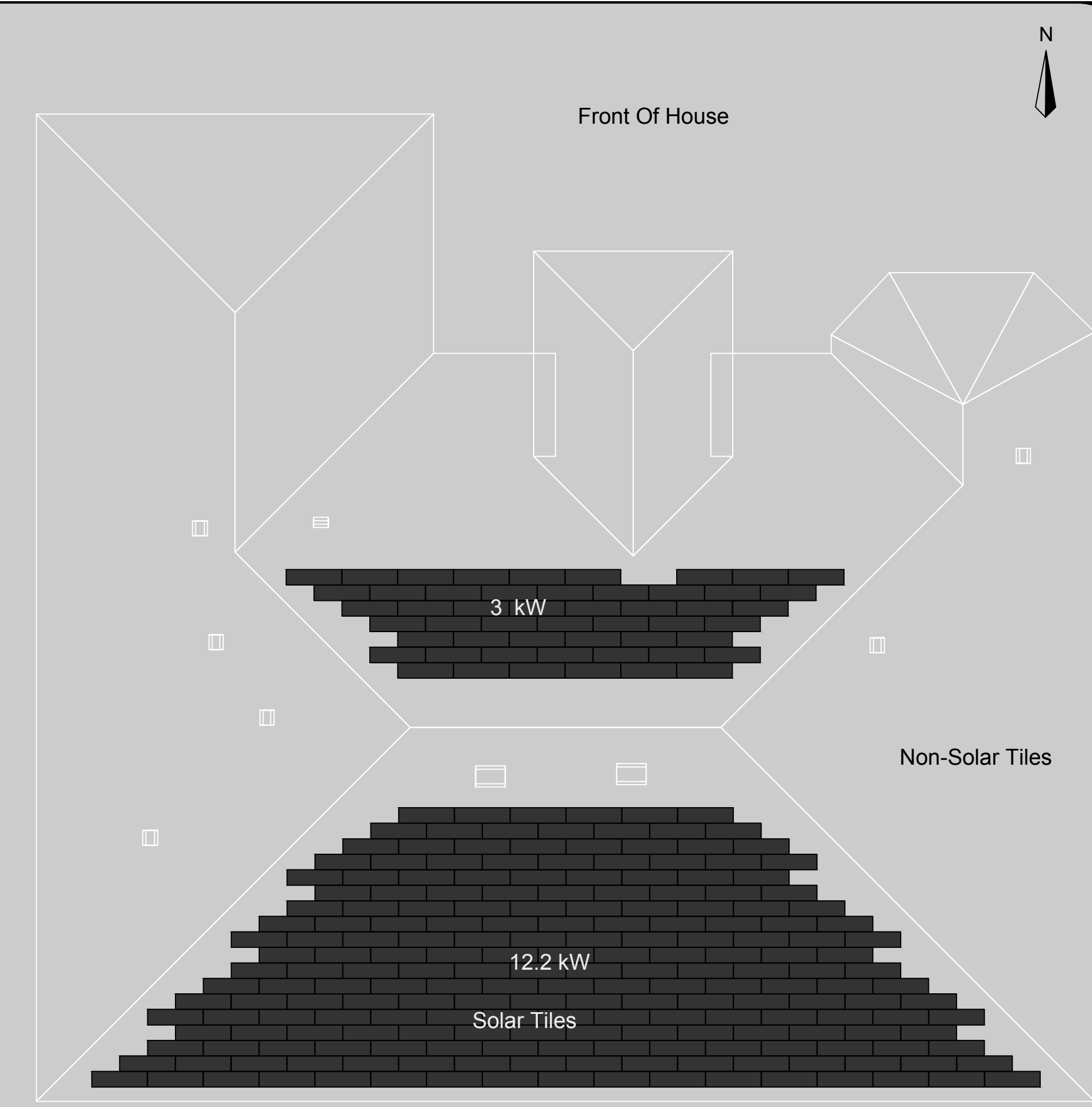

LEGEND

Solar Tiles

Non-Solar Tiles

Alternative Roof Surface

Rooftop vents, skylights, chimneys, and HVAC



Single Phase Solar Inverter for North America

M4-TL-US | M5-TL-US | M6-TL-US | M8-TL-US | M10-TL-US | M10-4-TL-US



Key Features:

- Smart inverter with BLE, optional WiFi, Ethernet, 3G / 4G cellular communication
- Optional revenue grade meter (compliant with ANSI C12.20, Class 0.5)
- Support bi-directional cloud communication
- Support remote diagnosis and OTA
- Type 4 protection
- Built-in AFCI & Rapid shutdown controller
- CEC efficiency 97.5%
- UL 1741 SA, HECO compliant
- CA Rule 21 Phase 1 & 2 & 3 compliant



Model	M4-TL-US	M5-TL-US	M6-TL-US	M8-TL-US	M10-TL-US	M10-4-TL-US
INPUT (DC)						
Max. system voltage	600 V					
Nominal voltage	380 V					
Max. operating voltage	540 V					
Operating MPPT voltage range	50 V to 480 V					
Max. input current per MPPT	12 A	12 A	12 A	12 A	20 A	10 A
Max. short circuit current per MPPT	15 A	15 A	15 A	15 A	30 A	15 A
Max. DC/AC ratio	1.3					
DC disconnect	Integrated					
MPP tracker	2	2	3	3	2	4
Input strings available	2 - 2	2 - 2	2 - 2 - 2	2 - 2 - 2	2 - 2	2 - 2 - 2 - 2
OUTPUT (AC)						
Nominal output power @ 240Vac	3840 W	4800 W	5760 W	7680 W	9600 W	9600 W
Max. output power @ 240Vac	4000 W	5000 W	6000 W	8000 W	10000 W	10000 W
Nominal output power @ 208Vac	3328 W	4160 W	4992 W	6656 W	8320 W	8320 W
Max. output power @ 208Vac	3648 W	4560 W	5472 W	7296 W	9120 W	9120 W
AC operating voltage range	183 Vac to 228 Vac @ 208 Vac 211 Vac to 264 Vac @ 240 Vac					
Max. continuous current	16 A	20 A	24 A	32 A	40 A	40 A
Nominal operating frequency	60 Hz					
Operating frequency range	59.3 Hz to 60.5 Hz					
Adjustable frequency range	50 Hz to 66 Hz					
Night consumption	< 1.5 W ¹⁾					
THD @ nominal power	< 3 %					
Power factor @ nominal power	> 0.99					
Adjustable power factor range	0.85i to 0.85c					
GENERAL SPECIFICATION						
Max. efficiency	98%					
CEC efficiency	97.0 % @ 208 V 97.5 % @ 240 V	97.5 % @ 208 V 97.5 % @ 240 V	97.0 % @ 208 V 97.5 % @ 240 V	97.5 % @ 208 V 97.5 % @ 240 V	97.5 % @ 208 V 97.5 % @ 240 V	97.0 % @ 208 V 97.5 % @ 240 V
Operating temperature range	-22 °F to 149 °F (-30 °C to 65 °C) with derating above 113 °F (45 °C)					
Storage temperature range	-40 °F to 185 °F (-40 °C to 85 °C)					
Humidity	0% to 95%					
Max. operating altitude	9,843 ft (3,000 m)					
Acoustic noise	< 45 dB(A) @ 3 ft (1m)					



Solar Inverter for North America

Model	M4-TL-US	M5-TL-US	M6-TL-US	M8-TL-US	M10-TL-US	M10-4-TL-US
MECHANICAL DESIGN						
Dimensions (W x H x D)	16.7 x 23.2 x 5.9 in (425 x 590 x 150 mm)					
Display	LED indicators					
Weight ²⁾	41.9 lbs (19.0 kg)	41.9 lbs (19.0 kg)	44.3 lbs (20.1 kg)	45.2 lbs (20.5 kg)	47.6 lbs (21.6 kg)	47.6 lbs (21.6 kg)
Cooling	Natural convection			Natural convection with internal fan		
DC connection	Spring contact type					
AC connection	Spring contact type					
Rapid Shutdown Initiation Method	Loss of AC or DC Disconnect					
Communication interface	BLE, optional WiFi, Ethernet, 3G / 4G cellular communication					
Enclosure material	Die-casting aluminum					
STANDARDS						
Enclosure protection rating	Type 4					
Safety	UL 1741, CSA-C22.2 No. 107.1-01					
Software approval	UL 1998					
Ground fault protection	UL 1741 CRD					
Anti-islanding protection	IEEE 1547, IEEE 1547.1					
EMC	FCC part 15 Class B					
AFCI	UL 1699B (Type 1), NEC 2017 Article 690.11					
Rapid shutdown protection	NEC 2017 690.12 ³⁾					
Integrated meter	ANSI C12.20, Class 0.5					
Grid support regulation	UL 1741 SA, California Rule 21 phase 1 & 2 & 3, HECO Compliant					
WARRANTY						
Standard warranty	10 years					

- 1) Without consumption of communication card
2) Without weight of revenue grade meter
3) Compliant with Tigo rapid shutdown system or APS rapid shutdown system



Delta Electronics (Americas), Ltd.

46101 Fremont Blvd, Fremont, CA 94538
Sales Email: Inverter.Sales@deltaww.com
Support Email: Inverter.Support@deltaww.com
Sales Hotline: +1-877-440-5851 or +1-626-369-8021
Support Hotline: +1-877-442-4832
Support (Intl.): +1-626-369-8019
Monday to Friday from 6am to 6pm PST (apart from Holidays)
www.Delta-Americas.com



SOLAR ROOF

DATASHEET



ROOFING SYSTEM SPECIFICATIONS

CERTIFICATIONS

UL Listed	ETL Listed
UL 61730	UL 790 Class A
UL 9703	TAS100
UL 1741	ASTM D3161 Class F

ELECTRICAL CHARACTERISTICS

Maximum open circuit voltage rating of connected branch circuits per diode (at STC): 13.34 V
Maximum series fuse rating: 10 A
Maximum system voltage: 600 V

ROOF PITCH RANGE

2:12 - 20:12

MODULE SPECIFICATIONS

MODEL #SR60T1 14-CELL MODULE

Irradiance (W/m ²)	Temp. (Celsius)	Voc (V)	Vmp (V)	Isc (A)	Imp (A)	Pmax (W)
1000	25	13.34	10.99	5.65	5.32	58.47

These electrical characteristics are within ± 5% of the indicated values of Isc, Voc, and Pmax under standard test conditions (irradiance of 1000 W/m², AM 1.5 spectrum, and a cell temperature of 25 °C or 77 °F).

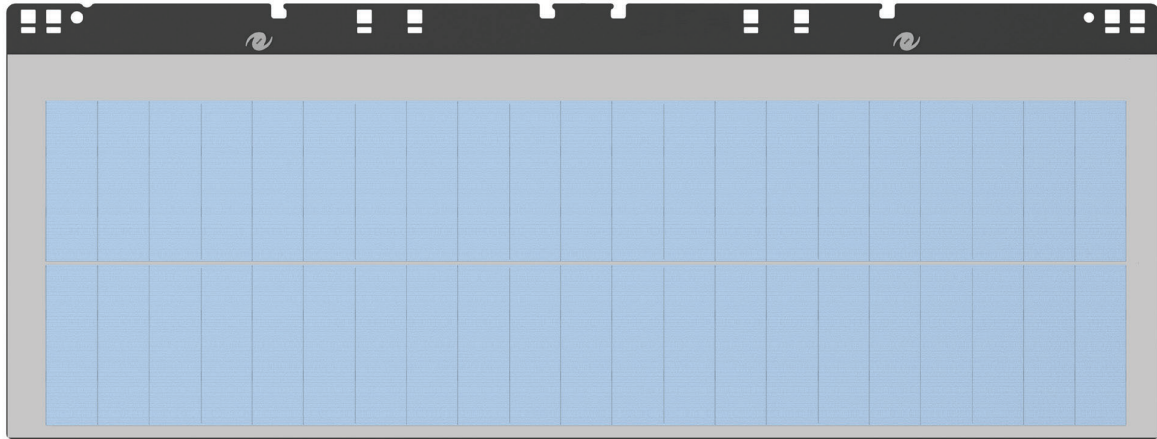

Dimensions	430 mm x 1140 mm Appx. 5 mm module thickness with 35.3 mm maximum height from deck
Principal Materials	Glass, Polymers, Fiberglass and Silicon
Installed System Weight	Textured Glass: 16.4 kg/m ² or 3.4 psf Installed weights include all components of system above roof sheathing

ROOFING MODULES, FULL AND PARTIAL

Model #SRNFT1/6, #SRNFT1/3, #SRNFT1/2, #SRNFT2/3, #SRNFT5/6 and #SRNFT1

Listed to UL 61730

Listed to UL 790 Class A

ASTM D3161 Class F

TAS100

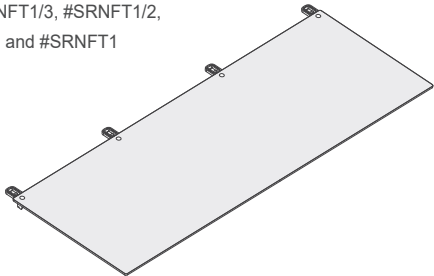

PV MODULE

Model #SR60T1

Listed to UL 61730

UL 790 Class A

ASTM D3161 Class F

TAS100

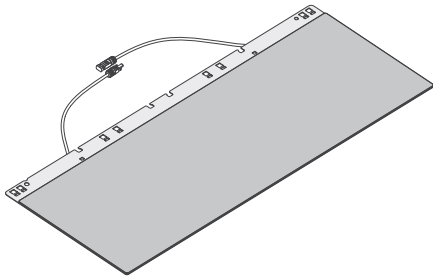

FOOT WITH SUPPORT

Model #SR-FOOTSUP

Listed to UL 790 Class A

ASTM D3161 Class F

TAS100

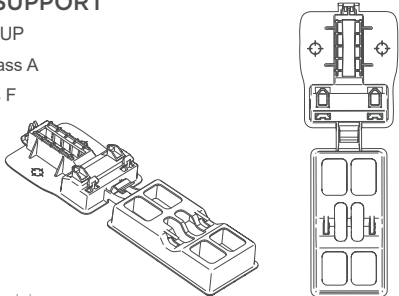

Center foot for PV module

FOOTLAP

Model #SR-FOOTLAP

Listed to UL 790 Class A

ASTM D3161 Class F

TAS100

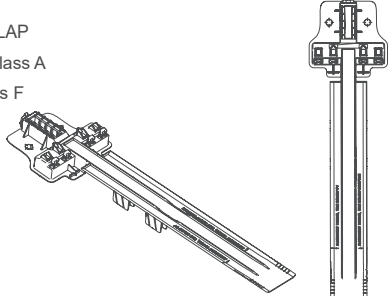

Edge foot for PV module

MCI RAPID SHUTDOWN

Model #EE-002605-003, Delta #GPI00010110

600V, 12A, NEMA 4X, MC4

Listed to UL 1741 PVRSE

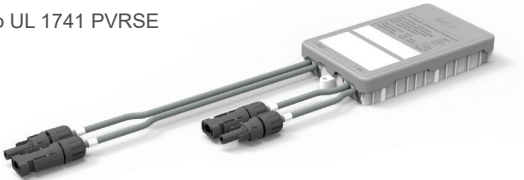

FIRESTONE UNDERLAYMENT

Clad-Gard SA FR

ASTM D226 Type I & II

Certified to ICC-ES AC188 (ESR-3979)

and ASTM D1970

Class A Fire Rated per ASTM E108

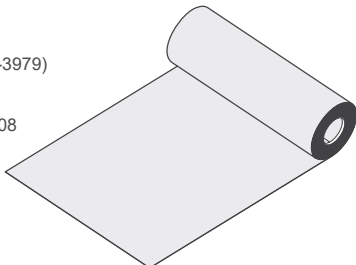

DIODE TRUNK HARNESS

Model #SRDTH

Listed to UL 9703

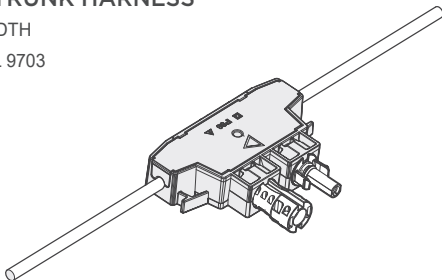

PASS THROUGH BOX

Model #SRPTB-4

Listed to UL 1741

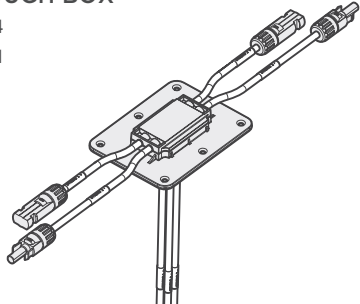

ROOFING FOOT

Model #SR-FOOT

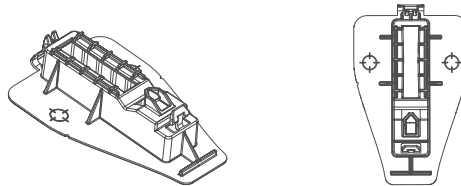

Center foot for Roofing module

BRANCH JUMPER

Model #SR-BJ2X, #SR-BJ3X, #SR-BJ4X, and #SR-BJMini

Listed to UL 9703

