

REVISIONS			
REV.	DESCRIPTION	DATE	APPROVED

ITEM NO.	PART NUMBER	DESCRIPTION	QTY.
1	FK1-N	FASTENER NUT	10
2	FK1-S	FK1-S Fastener Stud	10
3	D403-06	355x32x61 (14" BBK)	1
4	H801-55	Tesla Front	1

OE WT:29.5 LBS; RB BBK WT: 22 LBS
SAVING: 7.5 LBS PER ROTOR

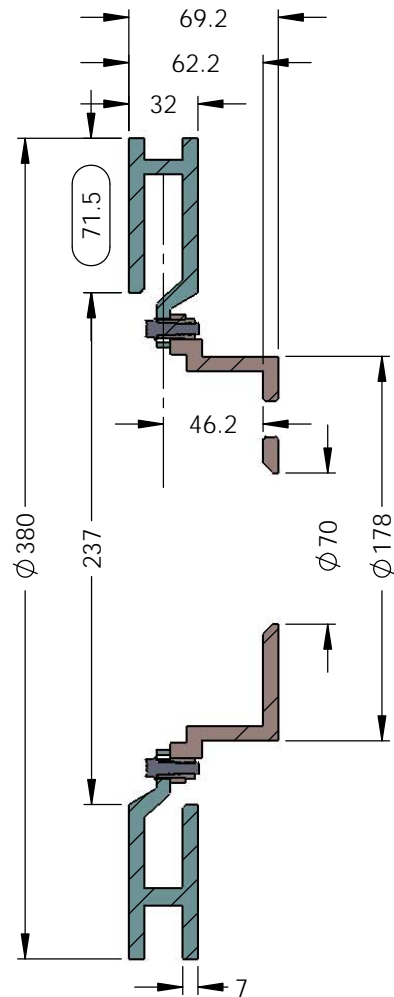

SECTION E-E

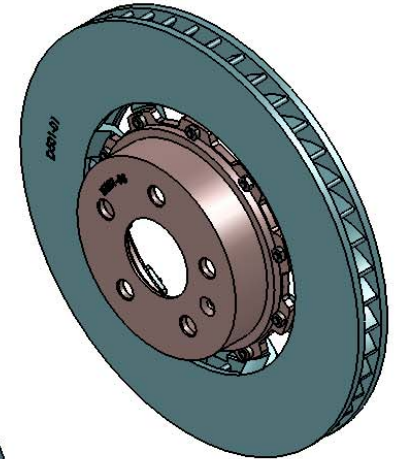
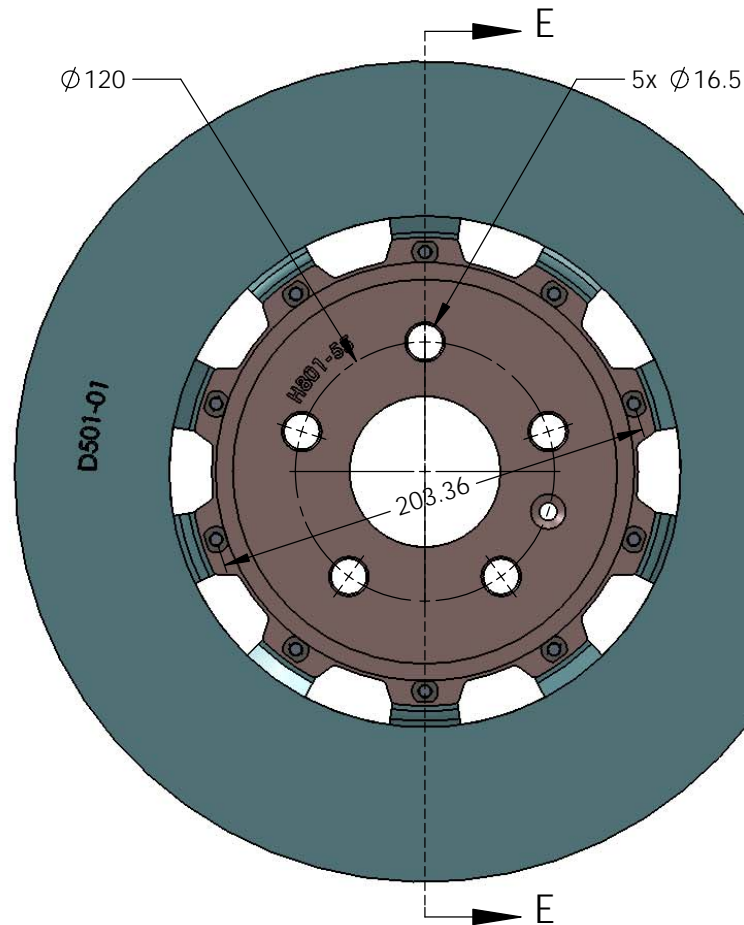

TPM PRODUCTS, INC.
FULLERTON, CA 92831

TITLE: Tesla Front BBK (380)

DWG#: 2466

Date Issued
7/24/15

BREAK ALL SHARP EDGES

PROPRIETARY AND CONFIDENTIAL

UNLESS OTHERWISE SPECIFIED:
DIMENSIONS ARE IN MM TWO PLACE
DECIMAL ±.10 FRACTIONAL ±
ANGULAR: MACH± BEND ±

THE INFORMATION CONTAINED IN THIS DRAWING IS
THE SOLE PROPERTY OF TPM PRODUCTS, INC. ANY
REPRODUCTION IN PART OR AS A WHOLE WITHOUT
THE WRITTEN PERMISSION OF TPM PRODUCTS, INC.
IS STRICTLY PROHIBITED.

MATERIAL: <Not Specified>

WEIGHT: (g) 10150.24

FINISH: <Not Specified>

BY

AF

WL

DATE

7/24/15

7/24/15

SCALE: 1:3.5

REV: