

A2

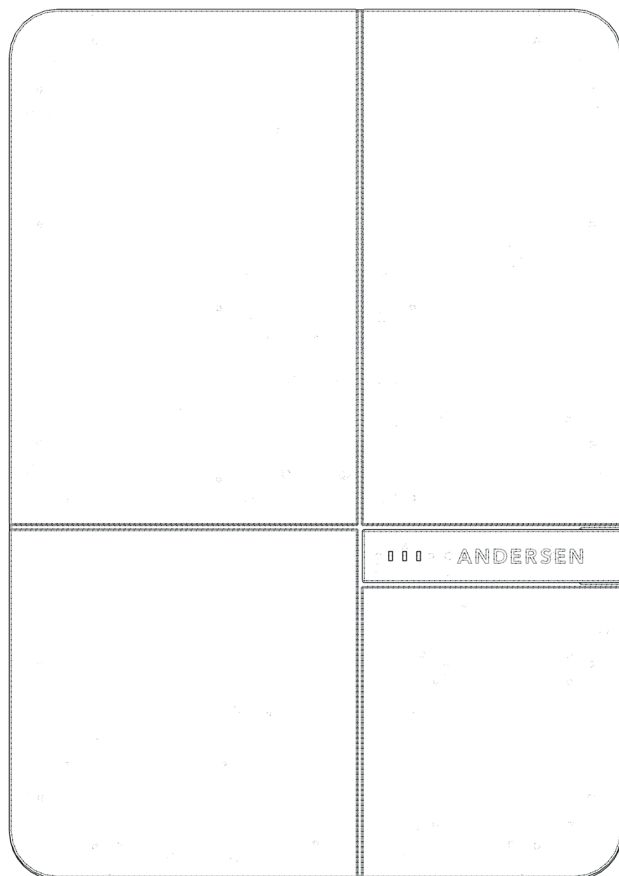

ANDERSEN

www.andersen-ev.com

A2-012020V2

ANDERSEN A2

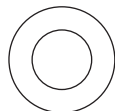
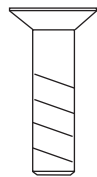
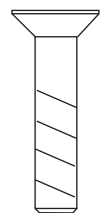
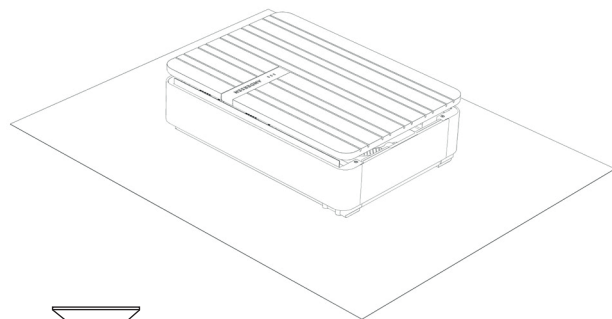
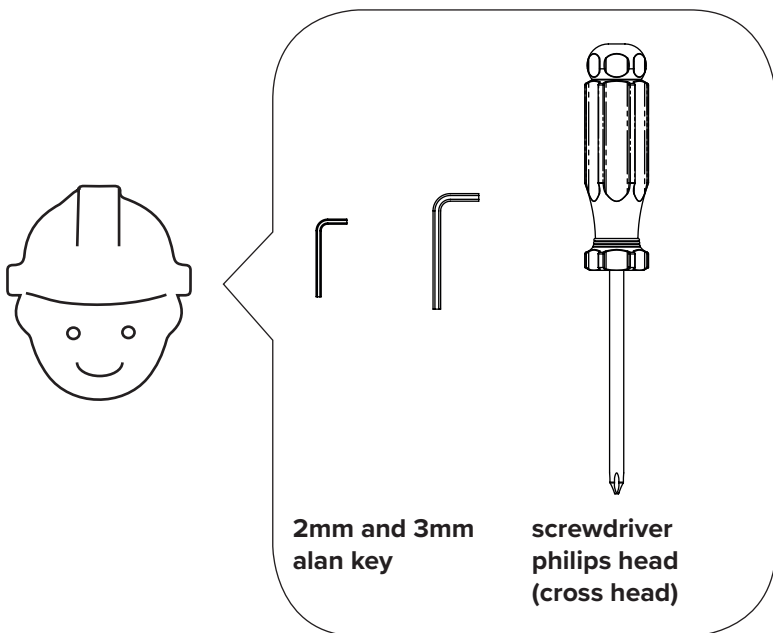

x29
M3 x 16mm
long screw

x2
M5 x 12mm
long screw

x4
M5 x 8mm
counter
sunk screw

x2
6mm
penny
washer

x2
6mm
washer

OPERATION LED STATUS



System powering up. Red, Amber, Green LED flash together twice a second



Standby State (solid green)



Vehicle connected state (solid green & solid amber)



Vehicle charging state (solid amber)



Charge point locked or awaiting scheduled charge (solid green & solid red)

ERROR & UPDATE LED STATUS

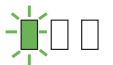

Disconnected from network/cloud (green LED flash every 5 seconds)

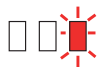

RCM or charge error (blip red every second)



Firmware upgrade (sequence of green, amber, red for duration of upgrade)

SETUP LED STATUS

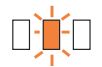

Wifi Setup (Amber LED flash once per second)



Reset warning. Red, Amber, Green LED flash 4 times per second.

SETUP MULTI FUNCTION OPERATION



x2 Reset RCM (Two button presses)



x3 Enter Network setup mode (Three button presses)



x1 Exit Network setup mode (One button press)



x5 Enter unit reset mode (Five button presses) + Exit Timeout 30 secs

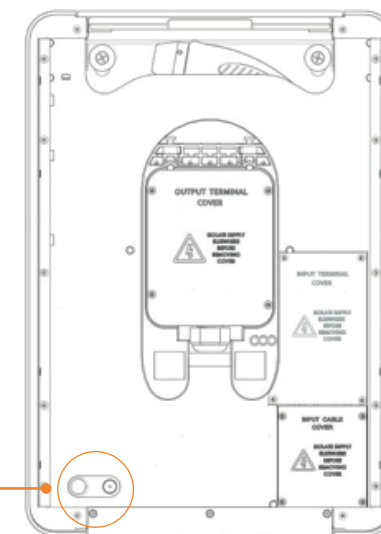

Multi function button located at the bottom left inside the cable slot

Step 1: Fix A2 unit to wall

x2
6mm penny washer

x2
6mm washer

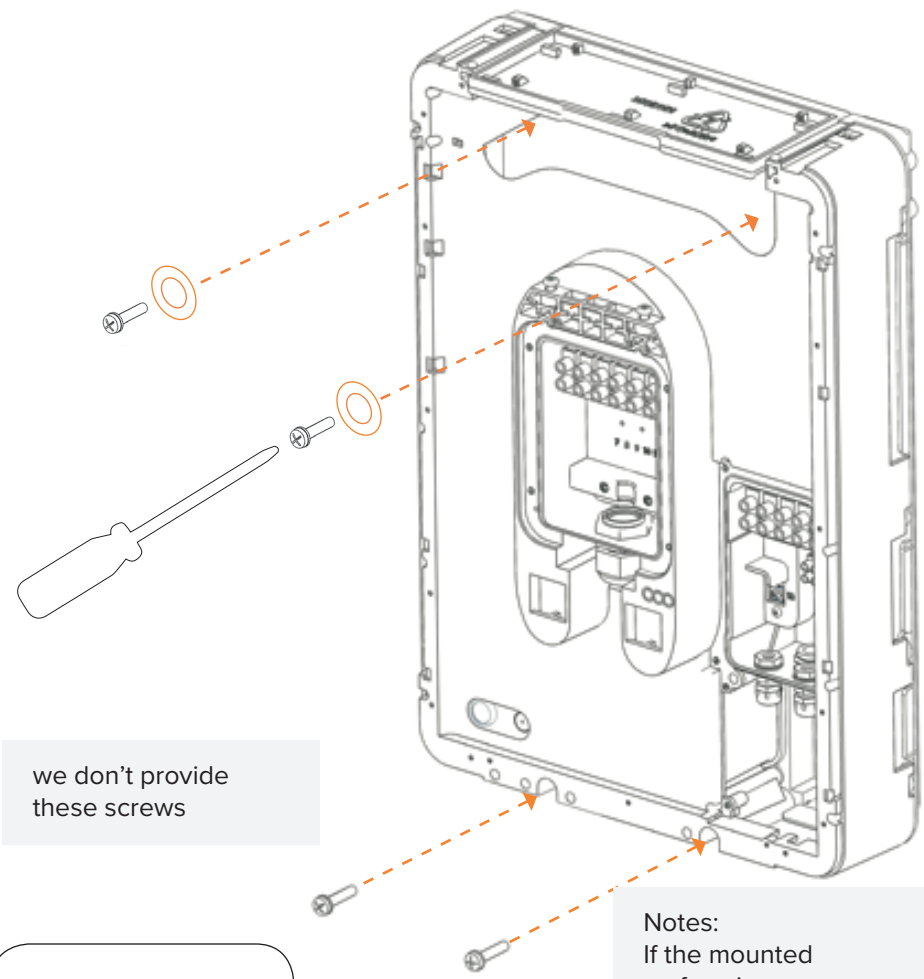

we don't provide
these screws

TIP!
Drill template on the
bottom of the unit

Notes:
If the mounted
surface is uneven use
spacers to ensure
the unit core is sitting
flush to the wall

Step 2: Prepare A2 core for supply cable entry

Default cable entry is from the rear See Fig: 1

Note:
this can be done on wall

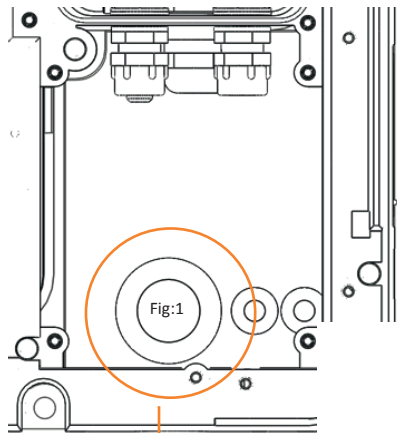

Fig 1

Bottom entry drill out cable entry section with 20 25mm hole saw, see Fig :2
Use rubber grommet from the rear cable entry hole

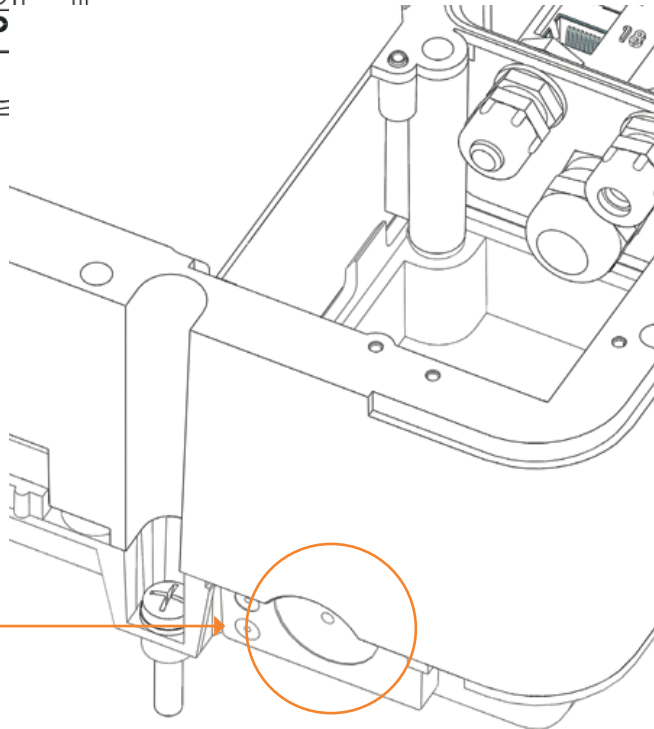
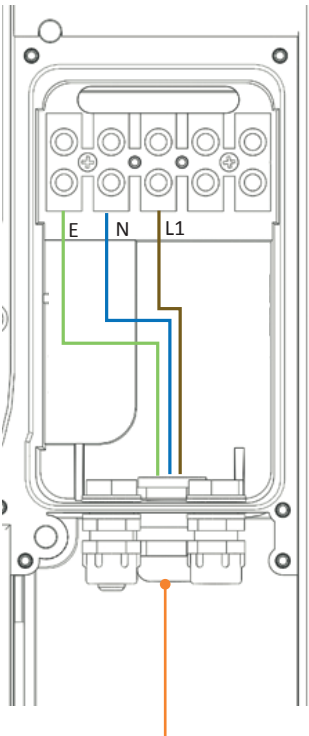

Fig 1

Step 3: Terminate supply power cable

Single Phase installation



Incoming single phase supply

Three Phase installation

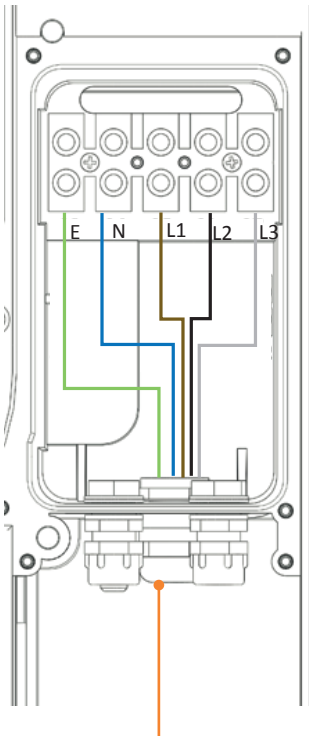

Incoming three phase supply

TIP!
Suggested cable types PVC or SWA

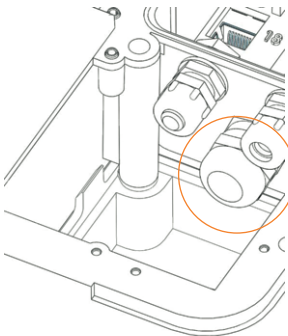

Important.
Make sure the gland is tightened after cable installation

Note:
HI TUFF cable not recommended, It is very difficult to terminate

Step 4: Terminate sensor & data cables

AEPS (Advanced Earth Protection System) Sensor

* Optional

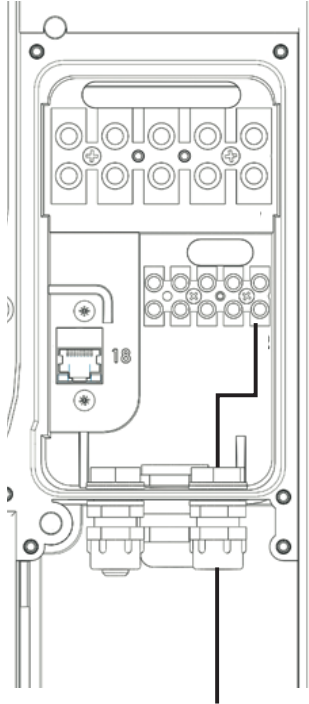

To AEPS sensor

Refer to earth protection pamphlet for installation information

Solar CT sensor cable

* Optional

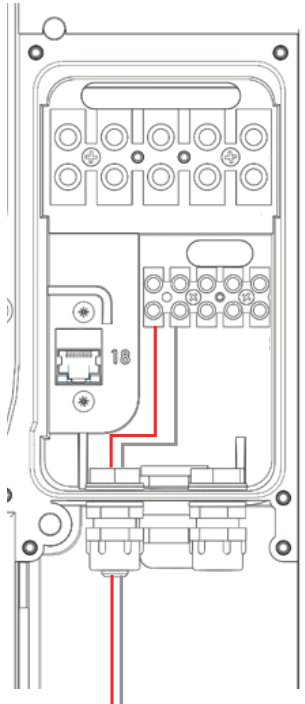

To solar CT

Note: Fix CT clamp to PV inverter supply. Orientation can be determined during testing.

Recommended Cable: Shielded twisted pair e.g. CAT5e/CAT6

Dynamic fuse CT sensor cable

* Optional

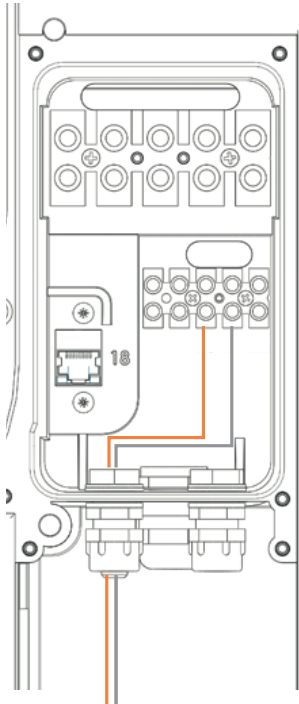

To dynamic fuse CT

Note: Fix CT clamp to incoming supply. Orientation can be determined during testing. Sensor orientation can be adjusted in dashboard using a load reference i.e. kettle 3Kw

Recommended Cable: Shielded twisted pair e.g. CAT5e/CAT6

If you have questions use our helpful support resources

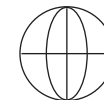

www.andersen-ev.com/support



support@Andersen-ev.com



+44 (0) 203 8904510



Andersen Chat

Step 5: Terminate vehicle side charge cable

Single Phase cable

Three Phase cable

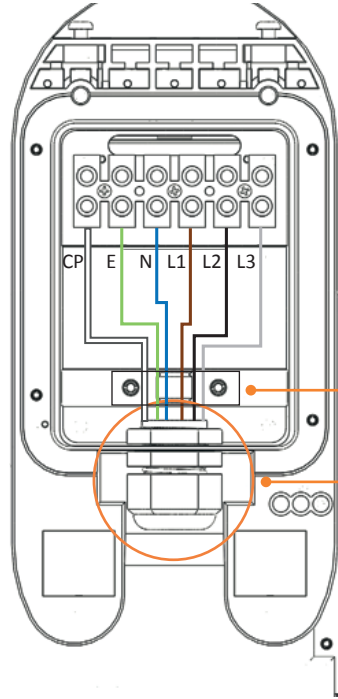
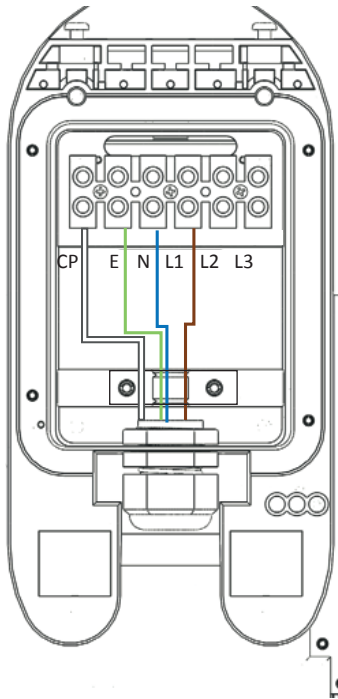

Orange cable not used

Important.
Ensure cable
stress relief
clamp is
correctly
tightened



Important.
Make sure
the gland is
tightened
after cable
installation!

Step 6: Fit weather project covers

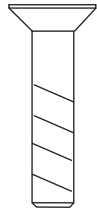

x12
M3 x 16mm long
countersunk screw
steel

Torque setting must be
2.5nM

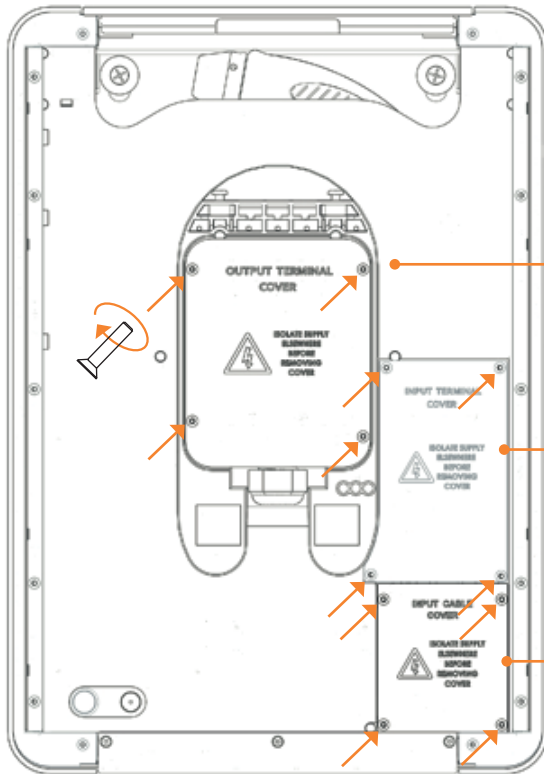

A: Fit Output terminal cover
Ensure seals are correctly
positioned and fixing
screws correctly torqued to
2.5nM

B: Fit input terminal cover
Ensure seals are correctly
positioned and fixing
screws correctly torqued
to 2.5nM

C: Fit input supply cover
Ensure seals are correctly
positioned and fixing
screws correctly torqued
to 2.5nM

Step 7: Fit side panels

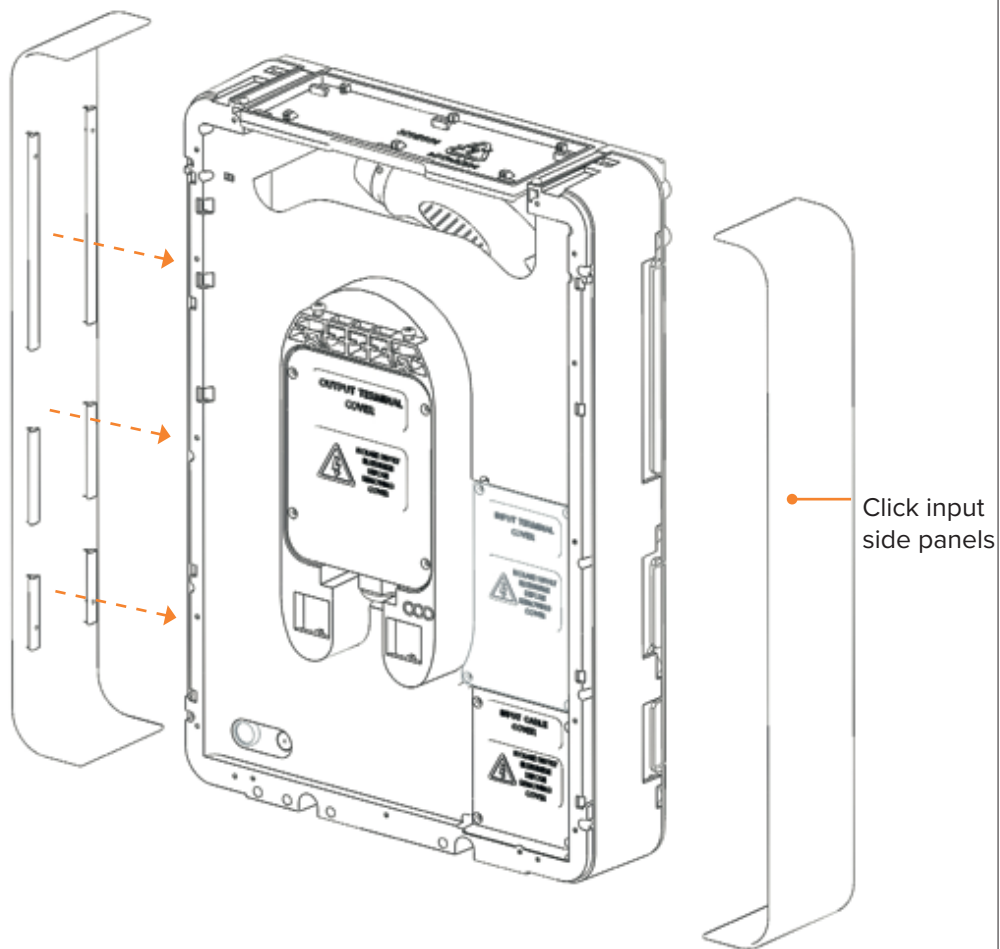

Note:
For further tips and
tricks see our support
videos

Step 8: Fit cable brushes

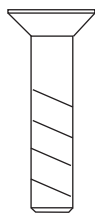

x14
M3 x 16mm long
screw

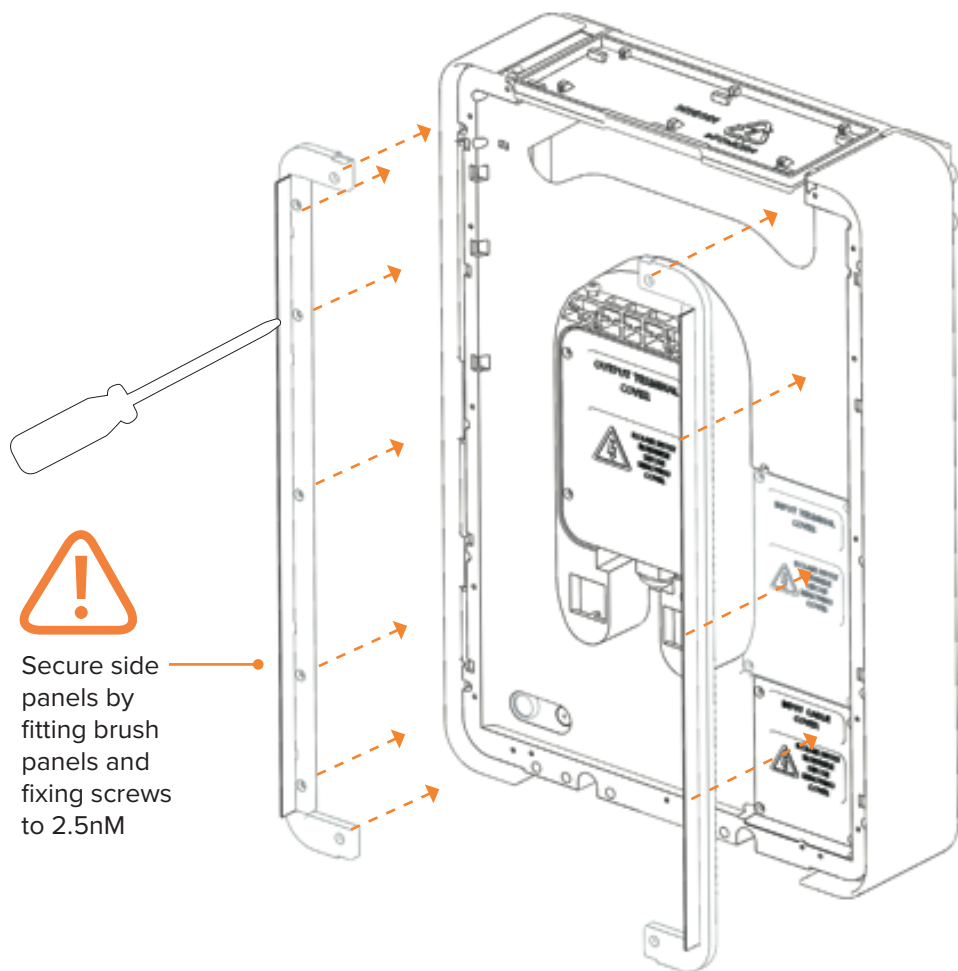

Secure side
panels by
fitting brush
panels and
fixing screws
to 2.5nM

Step 9: Fit lid panel



x4
M5 x 8mm counter sunk screw

A: Click lid panel into the lid core

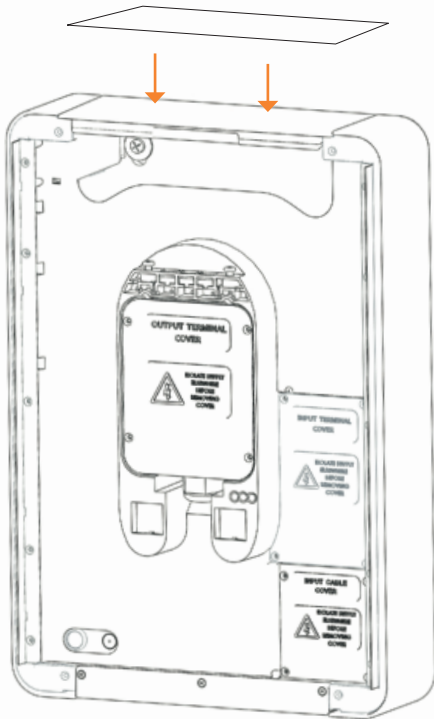

B: Insert and tighten lid fixing screws

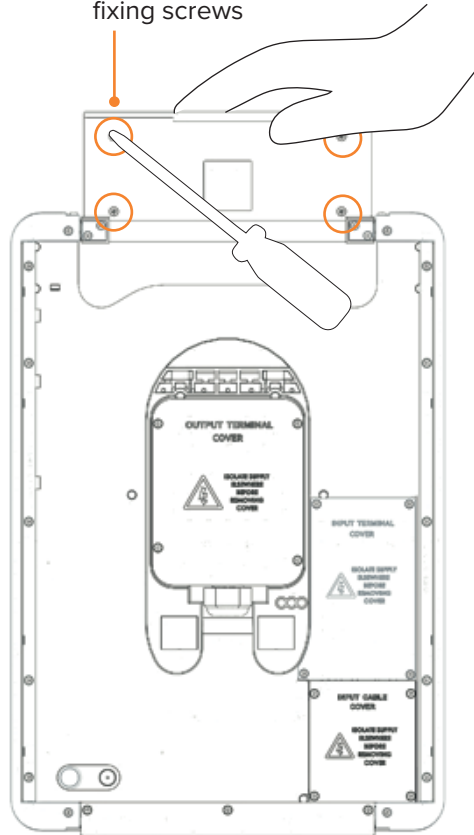

Note:
For further tips and
tricks see our support
videos

Step 10: Fit bottom panel

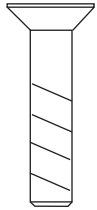

x3
M3 x 16mm long screw

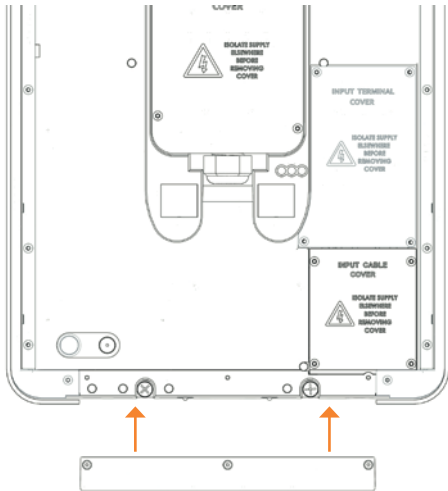

A: Fit bottom cover

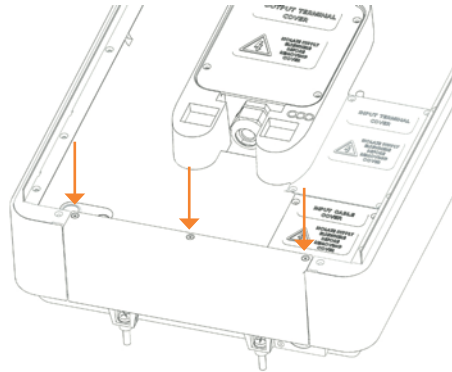

B: Tighten screws to 2.5nM

Note:
For further tips and tricks see our support videos

Step 11: Fit front panel

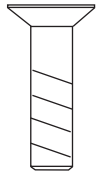

x2
M5 x 12mm long screw

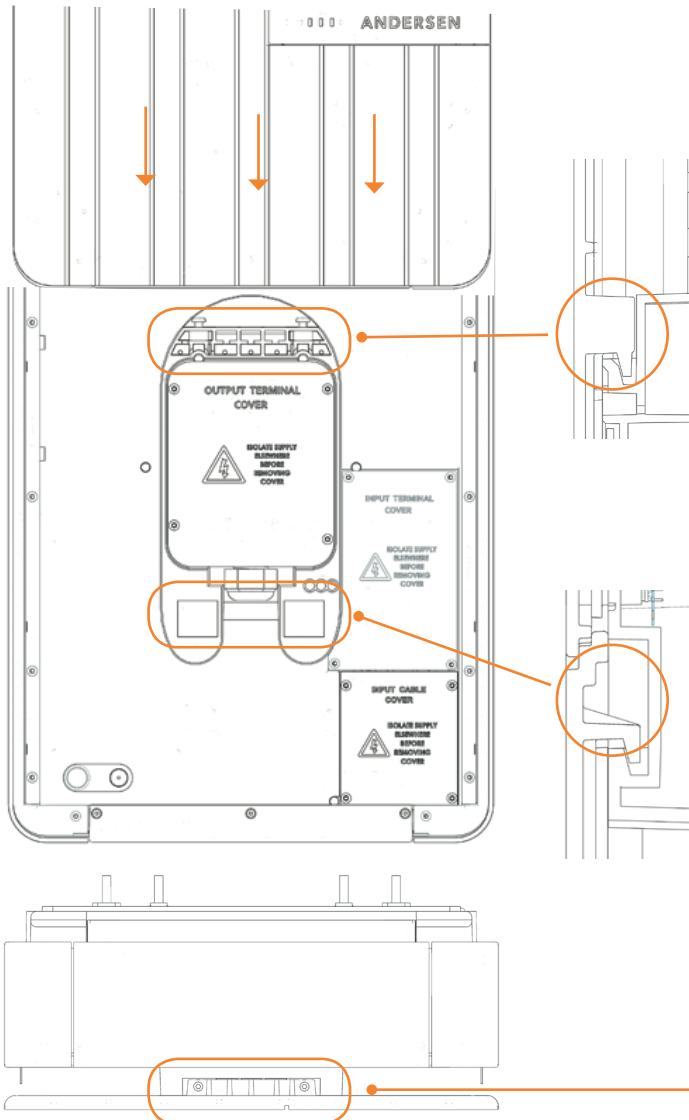

A: Ensure the front panel mounts are located into the slots correctly

B: insert and tighten front panel screws correctly torqued to 5nM .

Danger

Danger to life due to electrical voltage! Injuries due to electric shock and/or burns, possibly resulting in death, are possible.

During all work, make sure at all times that power to the system is switched off and secured so it cannot inadvertently be switched on.

- Before commissioning the device check that all screw and terminal connections are tight.
- The termination panel covers must never be left opened without supervision. Fit the termination panel cover when you leave the charge point.
- Do not make any unauthorised changes or modifications to the charge point.
- Repair work to the charge point may only be completed by the manufacturer or a trained expert.
- Do not remove any identifiers such as safety symbols, warning instructions, rating plates, labels or cable markings.
- Ensure that the charging cable is not mechanically damaged (kinked, jammed or run over) and that the contact area does not come into contact with heat sources, dirt or water.

Warning

Safety notice:

- Switch off on all poles and from all sources.
- Secure to prevent it being switched on again.
- Verify isolation from the supply.
- Earth and short-circuit.
- Cover neighbouring live parts and cordon off danger areas.

Caution

Ensure that the charge point is not damaged by incorrect handling (housing cover, internal parts, etc.).

On outdoor installations, do not open the termination panel cover in damp conditions.

Danger of breaking the plastic housing.

- Do not tighten the securing screws with force.
- The installation area must be completely flat, do not bend the housing.
- Electronic components may be damaged if handled. Before handling modules, perform an electrical discharge process by touching a metallic earthed object.

A failure to follow the safety information may result in a danger of death, injury and damage to the device. The device manufacturer cannot accept any liability for claims resulting from this.