

Drawing Name: O:\2023\2023141158 - TRT 58919 - Orlando, FL - Edgewater Dwg\2023141158 - ORLANDO, FL -  
EDGEWATER DR - CO 00.dwg  
June 29, 2023 9:50 AM - keel

TESLA

SUPERCHARGER STATION  
5820 EDGEWATER DR (TESLA SUPERCHARGER)  
ORLANDO, FL 32810  
TRT58919  
STORE ID: 5164

SITE LAYOUT

PROPERTY LINE AND RIGHT OF WAY BOUNDARIES  
ARE SHOWN FOR REFERENCE ONLY. REFER TO  
SURVEY BY OTHERS FOR EXACT LOCATION.

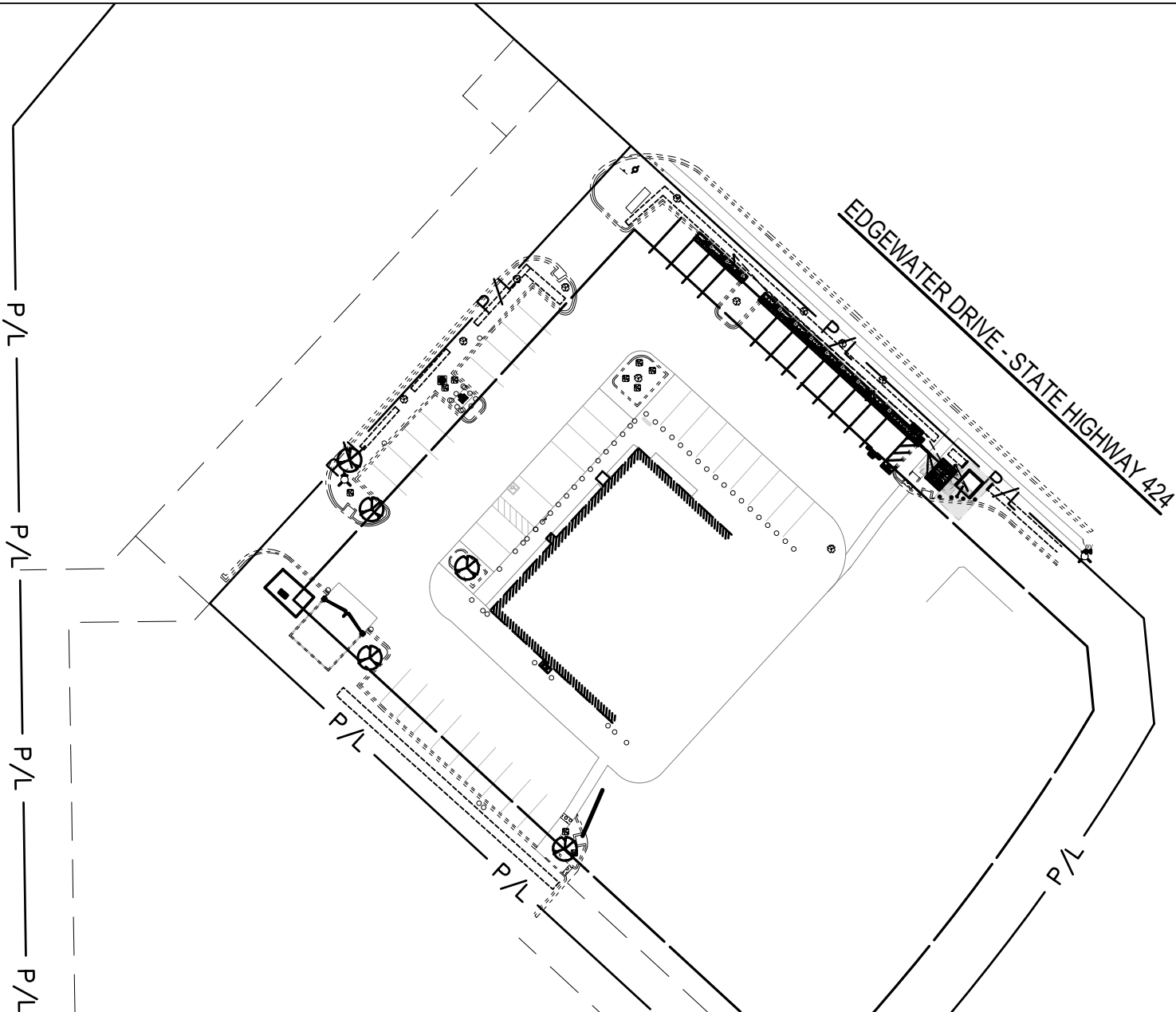

VICINITY MAP



NOT TO SCALE MAP DATA ©2023 GOOGLE



NOT TO SCALE

SITE INFORMATION

SITE ADDRESS  
5820 EDGEWATER DR (TESLA SUPERCHARGER)  
ORLANDO, FL 32810

APN  
04-22-29-0000-00-075

COUNTY  
ORANGE

LATITUDE (NAV88)  
N 28°36'38.2"  
28.610620°

LONGITUDE (NAV88)  
W 81°24'57.4"  
-81.415930°

PROJECT CONTACTS

UTILITY COMPANY  
DUKE  
CONTACT: ALVIN ETHEREDGE  
ALVIN.ETHEREDGE@DUKE-ENERGY.COM

PROPERTY OWNER  
5820 EDGEWATER, LLC  
CONTACT: JOHN G. BARTHELL

TESLA INSTALLATION MANAGER  
CHRIS GARRISON  
CHGARRISON@TESLA.COM  
(321) 403-9937

TESLA CONSTRUCTION MANAGER  
CHRIS GARRISON  
CHGARRISON@TESLA.COM  
(321) 403-9937

PERMITTING JURISDICTION  
CITY OF ORLANDO  
CONTACT: TBD

EOR CONTACTS:  
PROJECT MANAGER  
ISAAC MAHAM, PE - OH# 82452  
(614) 588-8946  
IMAHAM@GPDGROUP.COM

PROJECT COORDINATOR  
JADEN BEACHY, PE - OH# 88367  
(330) 572-3643  
JBEACHY@GPDGROUP.COM

PERMIT COORDINATOR  
BENJAMIN DALTON  
(614) 588-8851  
GPDCHARGEPERMITS@GPDGROUP.COM

UTILITY COORDINATOR  
ERIC HIPPLEY  
(330) 564-2310  
GPD.CHARGESITES.UC@GPDGROUP.COM

APPLICABLE CODES

ALL WORK SHALL COMPLY WITH THE FOLLOWING APPLICABLE CODES:

2020 FLORIDA BUILDING CODE, 7TH EDITION (2018 IBC)  
2017 NATIONAL ELECTRIC CODE

IN THE EVENT OF CONFLICT, THE MOST RESTRICTIVE CODE SHALL PREVAIL.

AS USED HEREIN, IBC SHALL REFER TO INTERNATIONAL BUILDING CODE AND NEC SHALL REFER TO NATIONAL ELECTRIC CODE

FDOT SPECIFICATIONS  
THE STANDARD SPECIFICATIONS OF THE STATE OF FL, DEPARTMENT OF TRANSPORTATION, INCLUDING CHANGES AND SUPPLEMENTAL SPECIFICATIONS SHALL GOVERN THIS IMPROVEMENT.

PROJECT DESCRIPTION

- INSTALL (3) SUPERCHARGER CABINETS
- INSTALL (12) SUPERCHARGER POSTS
- INSTALL (1) SWITCHGEAR ASSEMBLY WITH INTEGRATED TESLA SITE CONTROLLER AND PRIMARY BROADCAST UNIT
- INSTALL (1) UTILITY TRANSFORMER, (1) METER, AND OTHER ASSOCIATED UTILITY EQUIPMENT
- INSTALL (1) SECONDARY BROADCAST UNIT

FLOOD HAZARD NOTE

THE SITE IS LOCATED IN FLOOD ZONE "X" (AREA DETERMINED TO BE OUTSIDE THE 0.2% ANNUAL CHANCE FLOODPLAIN) PER FLOOD INSURANCE MAP NUMBER 12095C0235F, EFFECTIVE DATE: 09/25/2009.

PLAN REPRODUCTION WARNING

CONTRACTORS SHALL VERIFY ALL PLANS, EXISTING DIMENSIONS, AND FIELD CONDITIONS ON THE JOB SITE AND SHALL IMMEDIATELY NOTIFY OWNER IN WRITING OF ANY DISCREPANCIES BEFORE PROCEEDING WITH THE WORK OR BE RESPONSIBLE FOR SAME.

DESIGN LOADING

LATERAL LOAD DESIGN DATA:

WIND DESIGN DATA (ASCE 7-16):

BASIC WIND SPEED ( $V_{ULT}$ ) 135 MPH  
RISK CATEGORY II  
EXPOSURE CATEGORY C

SEISMIC DESIGN DATA (ASCE 7-16):

1.0 SEISMIC IMPORTANCE FACTOR (I) 1.0  
RISK CATEGORY II  
SITE CLASS (ASSUMED) D  
MAPPED SPECTRAL RESPONSE SHORT PERIODS ( $S_s$ ) 0.062  
1 SEC. PERIODS ( $S_1$ ) 0.034

SPECTRAL RESPONSE COEFF. SHORT PERIODS ( $S_{ps}$ ) 0.067  
1 SEC. PERIODS ( $S_{p1}$ ) 0.054

SEISMIC DESIGN CATEGORY A

FROST DEPTH 0"

SHEET INDEX

CIVIL	SHEET TITLE
C-001	COVER SHEET
	ENGINEERING DESIGN SURVEY (BY OTHERS)
C-002	TESLA DATASHEET (FOR REFERENCE ONLY)
C-003	CIVIL CONSTRUCTION NOTES
C-101	EXISTING CONDITIONS AND DEMOLITION PLAN
C-111	CIVIL SITE PLAN
C-201	CIVIL DETAILS
C-202	CIVIL DETAILS
ELECTRICAL	
E-001	ELECTRICAL GENERAL NOTES
E-100	OVERALL ELECTRICAL SITE PLAN
E-101	ELECTRICAL SITE PLAN
E-201	SINGLE LINE DIAGRAM & PANEL SCHEDULE
E-301	ELECTRICAL DETAILS
E-401	DURALINE SPECIFICATIONS

"This file was signed electronically by L. Sfera on the date and/or time stamp shown using a digital signature. Printed copies of this are not considered signed and sealed and the signature must be verified on any electronic copy.

REFERENCED DOCUMENTS

- SUPERCHARGER INSTALLATION MANUAL
- SUPERCHARGER POST INSTALLATION MANUAL
- UTILITY DESIGN DOCUMENTS
- ELECTRICAL EQUIPMENT CUTSHEETS

TESLA SUPERCHARGER STATION  
5820 EDGEWATER DR  
ORLANDO, FL 32810

PROJECT MANAGER	DESIGNER
IM	KSB

JOB NO.  
2023141158  
Division of Building Safety

Permit  
22904852  
Date  
7/15/23

C-001

This Approval does not grant permission to violate any applicable code. Enforcement of any part of this improvement can result in a close on the title of this property. Keep this plan on the job site at all times.

TESLA  
3500 DEER CREEK RD.  
PALO ALTO, CA 94304  
(650) 681-5000

GPD GROUP, INC.®  
LIC. # - 30920

520 South Main Street, Suite 2531  
Akron, OH 44311  
330.572.2100 Fax 330.572.2101

REV.	DATE	DESCRIPTION
A	04/14/2023	ISSUED FOR 50% REVIEW
B	06/15/2023	ISSUED FOR 90% REVIEW
C	06/29/2023	ISSUED FOR SIGN & SEAL

LEONARDO A. SFERRA  
LICENSE No. 80859

