



# HARLINGEN, TX - STUART PLACE CROSSING

**SITE ADDRESS:**  
**6710 WEST EXPRESSWAY 83**  
**HARLINGEN, TX 78552**  
**TRT ID: 20545**



Dewberry Engineers Inc.  
 4055 LA JOLLA DRIVE  
 SAN DIEGO, CA 92108

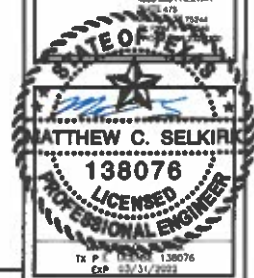

SITE INFORMATION	APPLICABLE CODES	PROJECT DESCRIPTION	ZONING INFORMATION	DRAWING INDEX																										
<b>PROPOSED TESLA EV SITE ADDRESS:</b> 6710 WEST EXPRESSWAY 83 HARLINGEN, TX 78552  <b>PROPERTY OWNER:</b> VARIO INVESTMENTS LTD 222 N EXPRESSWAY #200 BROWNSVILLE, TX 78521-2258  <b>PARCEL ID:</b> APN: 406608  <b>POWER COMPANY:</b> MARRIAGE VALLEY ELECTRIC CO-OP (MVEC) SERVICE ORDER #: 6234115  <b>COUNTY:</b> CAMERON COUNTY  <b>LATITUDE:</b> 26° 11' 18.46" N  <b>LONGITUDE:</b> 87° 49' 33.56" W *BASED ON GOOGLE EARTH  <b>CONTACT ENGINEER:</b> STEPHEN STOUT DEWBERRY ENGINEERS INC. (973) 434-1354 SSTOUT@DEWBERRY.COM	ALL WORK SHALL COMPLY WITH THE FOLLOWING APPLICABLE CODES: CITY OF HARLINGEN UNIFORM BUILDING & ENERGY CODES, CONSISTENT WITH THE FOLLOWING CODES: 2018 INTERNATIONAL BUILDING CODE 2018 INTERNATIONAL ENERGY CONSERVATION CODE 2018 INTERNATIONAL FIRE CODE 2017 NATIONAL ELECTRIC CODE (NEC)  IN THE EVENT OF CONFLICT, THE MOST RESTRICTIVE CODE SHALL PREVAIL.	<ul style="list-style-type: none"> <li>INSTALL (3) TESLA V3 SUPERCHARGER CABINETS</li> <li>INSTALL (15) TESLA CHARGING PORTS</li> <li>INSTALL (1) 1750A TV-1C, 277/480V MLD PANELBOARD</li> <li>INSTALL (1) UTILITY TRANSFORMER FOUNDATION</li> </ul>	JURISDICTION: CITY OF HARLINGEN, TX APN: 406608 LAND USE: COMMERCIAL ZONING: F1	<table border="1"> <thead> <tr> <th>SHT. NO.</th> <th>SHEET TITLE</th> </tr> </thead> <tbody> <tr> <td>T-1</td> <td>TITLE SHEET</td> </tr> <tr> <td>DN-1</td> <td>GENERAL NOTES I</td> </tr> <tr> <td>DN-2</td> <td>GENERAL NOTES II</td> </tr> <tr> <td>C-1</td> <td>SITE PLAN</td> </tr> <tr> <td>C-2</td> <td>EXISTING CONDITIONS PLAN</td> </tr> <tr> <td>C-3</td> <td>EQUIPMENT/PARKING PLAN</td> </tr> <tr> <td>C-4</td> <td>CONSTRUCTION DETAILS I</td> </tr> <tr> <td>C-5</td> <td>CONSTRUCTION DETAILS II</td> </tr> <tr> <td>C-6</td> <td>CONSTRUCTION DETAILS III</td> </tr> <tr> <td>E-1</td> <td>ELECTRICAL ONE-LINE DIAGRAM</td> </tr> <tr> <td>E-2</td> <td>ELECTRICAL &amp; UTILITY DETAILS</td> </tr> <tr> <td>G-1</td> <td>GROUNDING PLAN, SCHEMATIC &amp; DETAILS</td> </tr> </tbody> </table>	SHT. NO.	SHEET TITLE	T-1	TITLE SHEET	DN-1	GENERAL NOTES I	DN-2	GENERAL NOTES II	C-1	SITE PLAN	C-2	EXISTING CONDITIONS PLAN	C-3	EQUIPMENT/PARKING PLAN	C-4	CONSTRUCTION DETAILS I	C-5	CONSTRUCTION DETAILS II	C-6	CONSTRUCTION DETAILS III	E-1	ELECTRICAL ONE-LINE DIAGRAM	E-2	ELECTRICAL & UTILITY DETAILS	G-1	GROUNDING PLAN, SCHEMATIC & DETAILS
SHT. NO.	SHEET TITLE																													
T-1	TITLE SHEET																													
DN-1	GENERAL NOTES I																													
DN-2	GENERAL NOTES II																													
C-1	SITE PLAN																													
C-2	EXISTING CONDITIONS PLAN																													
C-3	EQUIPMENT/PARKING PLAN																													
C-4	CONSTRUCTION DETAILS I																													
C-5	CONSTRUCTION DETAILS II																													
C-6	CONSTRUCTION DETAILS III																													
E-1	ELECTRICAL ONE-LINE DIAGRAM																													
E-2	ELECTRICAL & UTILITY DETAILS																													
G-1	GROUNDING PLAN, SCHEMATIC & DETAILS																													
<b>CONTRACTOR NOTE</b> CONTRACTOR SHALL COMPLETE INSTALL PER THE SIGNED AND SEALED SET OF DRAWINGS. ANY NECESSARY DEVIATIONS FROM THE DRAWINGS MUST BE SUBMITTED THROUGH AN RFI REQUEST PROCESS WITH ENGINEERING FOR AN APPROVAL PRIOR TO CONTRACTOR PROCEEDING WITH A DEVIATION OF THE SIGNED AND SEALED SET OF DRAWINGS.	<div style="display: flex;"> <div style="flex: 1;"> <b>AERIAL MAP</b>  </div> <div style="flex: 1;"> <b>LOCATION MAP</b>  </div> </div>																													
<b>BEFORE SCALING</b> CONTRACTOR SHALL VERIFY ALL PLANS AND EXISTING DIMENSIONS AND CONDITIONS ON THE JOB SITE AND SHALL IMMEDIATELY NOTIFY THE TESLA REPRESENTATIVE IN WRITING OF DISCREPANCIES BEFORE PROCEEDING WITH THE WORK OR BE RESPONSIBLE FOR SAME.																														
<b>CALL BEFORE YOU DIG</b> 																														

**DRAWN BY:** FG

**CHECKED BY:** SES

**APPROVED BY:** MCS

**PROJECT #:** 30123704

**JOB #:** 50147800

## SUBMITTALS

REV	DATE	DESCRIPTION
0	02/22/22	ISSUED FOR PERMITS
B	02/08/22	ISSUED FOR 90% REVIEW
A	01/31/22	ISSUED FOR 90% REVIEW

## SITE NAME:

HARLINGEN, TX -  
 STUART PLACE CROSSING  
 TRT ID: 20545

## SITE ADDRESS:

6710 WEST EXPRESSWAY 83,  
 HARLINGEN, TX 78552

## SHEET TITLE

TITLE SHEET

## SHEET NUMBER

T-1

TEXAS ONE CALL  
 811 OR 1-800-344-0377

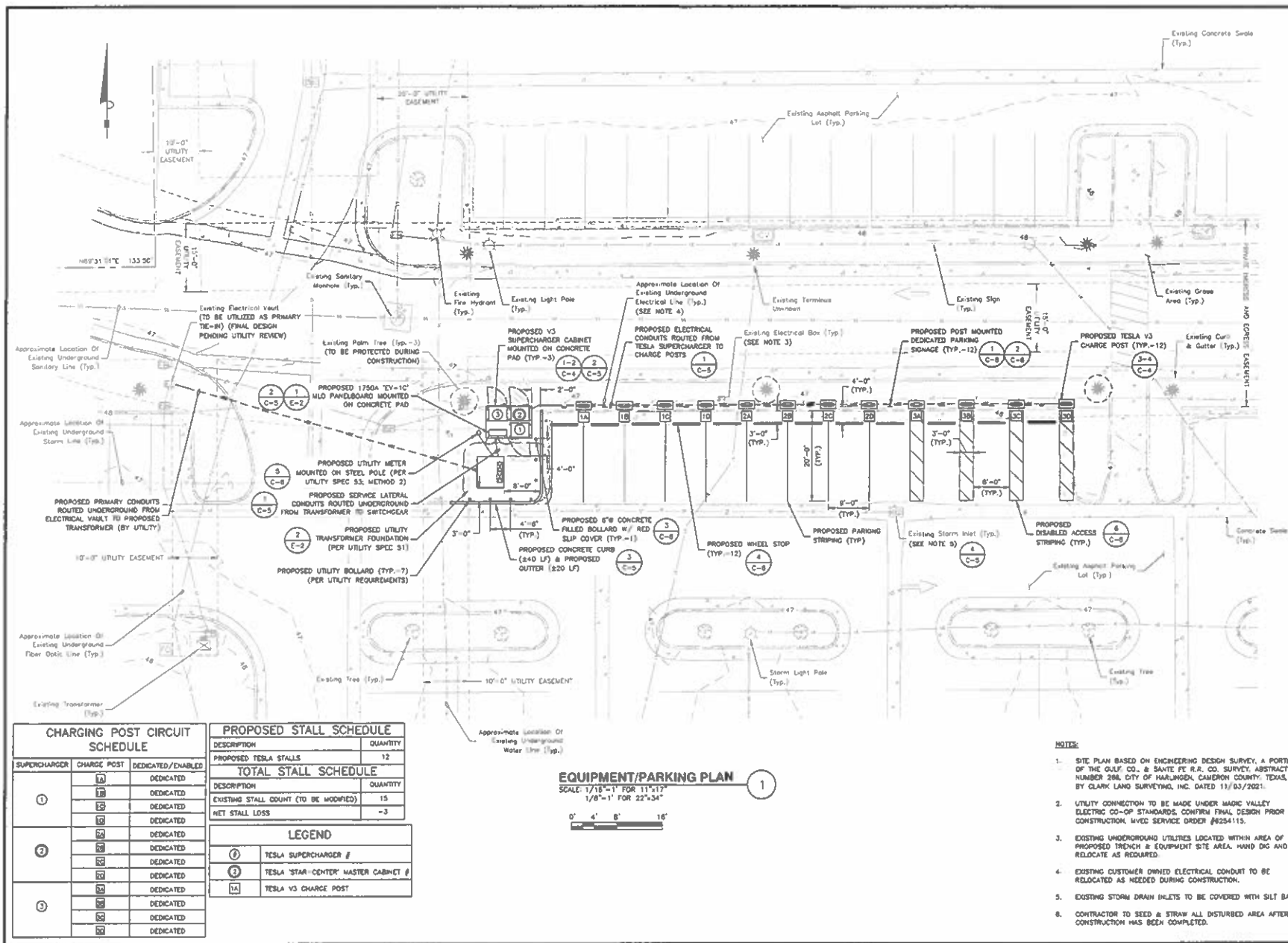

CHARGING POST CIRCUIT SCHEDULE		
SUPERCHARGER	CHARGE POST	DEDICATED/ENABLED
1	1A	DEDICATED
	1B	DEDICATED
	1C	DEDICATED
2	2A	DEDICATED
	2B	DEDICATED
	2C	DEDICATED
3	3A	DEDICATED
	3B	DEDICATED
	3C	DEDICATED

PROPOSED STALL SCHEDULE	
DESCRIPTION	QUANTITY
PROPOSED TESLA STALLS	12
TOTAL STALL SCHEDULE	
DESCRIPTION	QUANTITY
EXISTING STALL COUNT (TO BE MODIFIED)	15
NET STALL LOSS	-3
LEGEND	
1	TESLA SUPERCHARGER #
2	TESLA 'STAR-CENTER' MASTER CABINET #
3A	TESLA V3 CHARGE POST



- NOTES:**
- SITE PLAN BASED ON ENGINEERING DESIGN SURVEY, A PORTION OF THE GULF CO. & SANTA FE R.R. CO. SURVEY, ABSTRACT NUMBER 286, CITY OF HARLINGEN, CAMERON COUNTY, TEXAS, BY CLARK LAND SURVEYING, INC. DATED 11/03/2021.
  - UTILITY CONNECTION TO BE MADE UNDER MARIC VALLEY ELECTRIC CO-OP STANDARDS. CONFIRM FINAL DESIGN PRIOR TO CONSTRUCTION. MVED SERVICE ORDER #6254115.
  - EXISTING UNDERGROUND UTILITIES LOCATED WITHIN AREA OF PROPOSED TRENCH & EQUIPMENT SITE AREA. HAND DIG AND RELOCATE AS REQUIRED.
  - EXISTING CUSTOMER OWNED ELECTRICAL CONDUIT TO BE RELOCATED AS NEEDED DURING CONSTRUCTION.
  - EXISTING STORM DRAIN INLETS TO BE COVERED WITH SILT BAG.
  - CONTRACTOR TO SEED & STRAW ALL DISTURBED AREA AFTER CONSTRUCTION HAS BEEN COMPLETED.

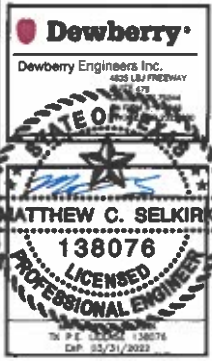

DRAWN BY:	FG
CHECKED BY:	SES
APPROVED BY:	MCS
PROJECT #:	50123704
JOB #:	50147800

SUBMITTALS		
REV	DATE	DESCRIPTION
0	02/22/23	ISSUED FOR PERMITS
B	02/09/23	ISSUED FOR 90% REVIEW
A	01/31/22	ISSUED FOR 90% REVIEW

**SITE NAME:**  
 HARLINGEN, TX -  
 STUART PLACE CROSSING  
 TRT ID: 20545

**SITE ADDRESS:**  
 6710 WEST EXPRESSWAY 83,  
 HARLINGEN, TX 78552

**SHEET TITLE:**  
 EQUIPMENT/  
 PARKING PLAN

**SHEET NUMBER:**  
 C-3