

INGENEXT

EXTEND THE POWER

User Manual Boost 50 Module

After installing the Boost 50 module in your car:

1. Search the Ingenext Wifi network on your smartphone, tablet or laptop.
2. Log in with the following password: ingenext
3. Open a web browser page and type **192.168.0.1** in the address bar. A window asks you to change the password, choose a personal password of at least 8 characters.
4. After changing the password, you will be disconnected from Wifi. Reconnect to Wifi with your new password, return to the web browser window. Here you go, you can modify commands. We recommend that you turn off the "automatic connection to this network" function in the Wifi settings of the Ingenext network.

Battery Pack Heating

- The battery heating function works only if the battery is below 30 degrees Celsius. To activate the function, the vehicle must be ON, so the driver must be seated in the driver's seat with the foot on the brake or the passenger activates the function while the vehicle is moving. A message will then appear in the dashboard: **Preparing the battery for Supercharging.**

Drift Mode

- The drift mode deactivates all driving aids: automatic emergency braking, regenerative braking, stability control, traction control system. You can activate it when the car is on Park or on the road.
- To deactivate it, you must first deactivate it in the browser. Then you must turn off the car by going to safety,

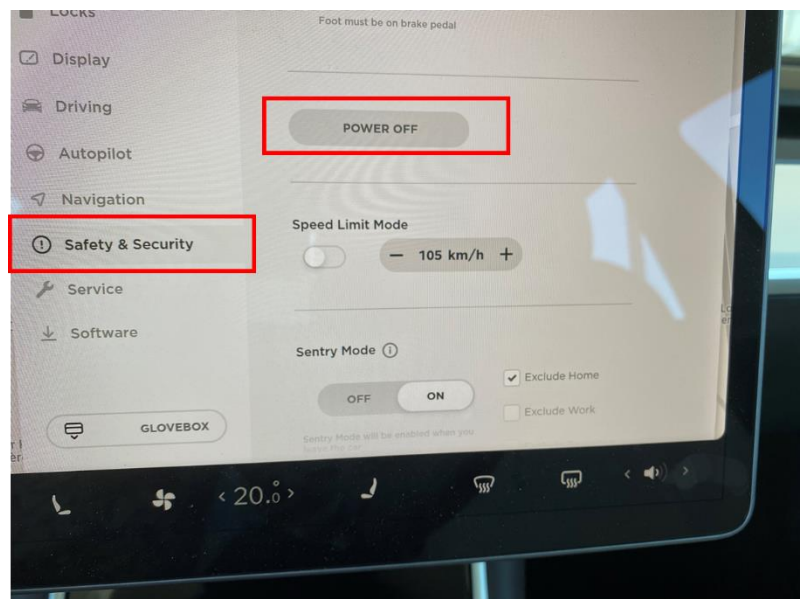

turn off (like the picture on the right). The screen will go off, wait 5 seconds and press the brake, this will restart the car.

Automatic driver door (beta)

- This function allows the driver's door to open automatically when the driver approaches with his Bluetooth key or the phone key. For correct operation, the vehicle must not be on standby. You can activate the sentinel mode so that the car wakes up when you approach or pre-condition from the mobile application. For this function to be activated several times, the telephone key must be disconnected for at least 15 seconds before allowing the automatic door to reopen. For example, you go get something from your car, close the door, go away and come back to your car, it will not open automatically. It will ONLY open if the key has been disconnected for 15 seconds or more. The **open door proximity detection** parameter can be adjusted from Closest to Farthest depending on the strength of your Bluetooth signal. We recommend that you test your car. You can start by putting it to closest. This will prevent the door from opening unnecessarily if you are near your car (ex the car is in the garage and you are near the garage). We also recommend that you activate in the car : Lock, Lock confirmation sound. Like this, if the door opens, the car will beep, and you will know that the door is open.

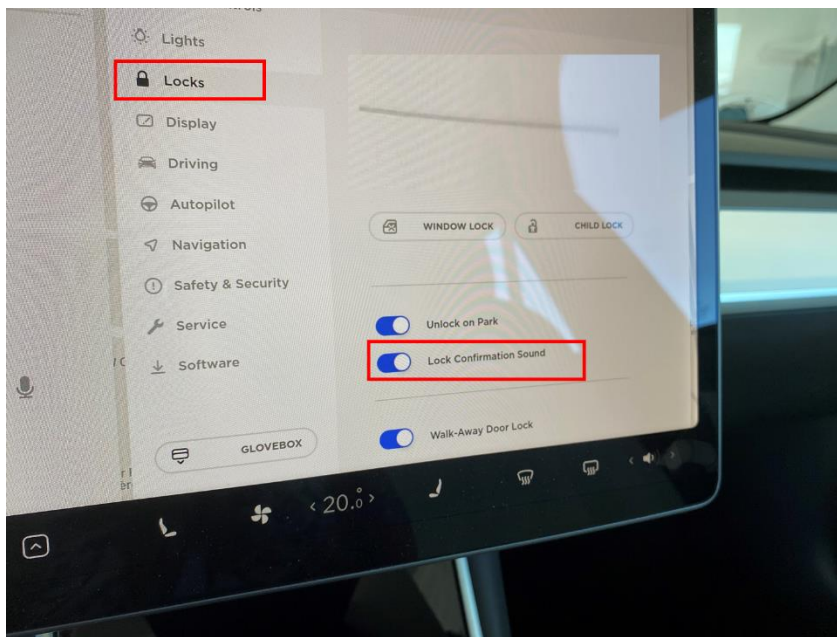

Any reproduction or use in any form in whole or in part of this document is strictly prohibited without the authorization of the authors.