

Wire Details

Version E

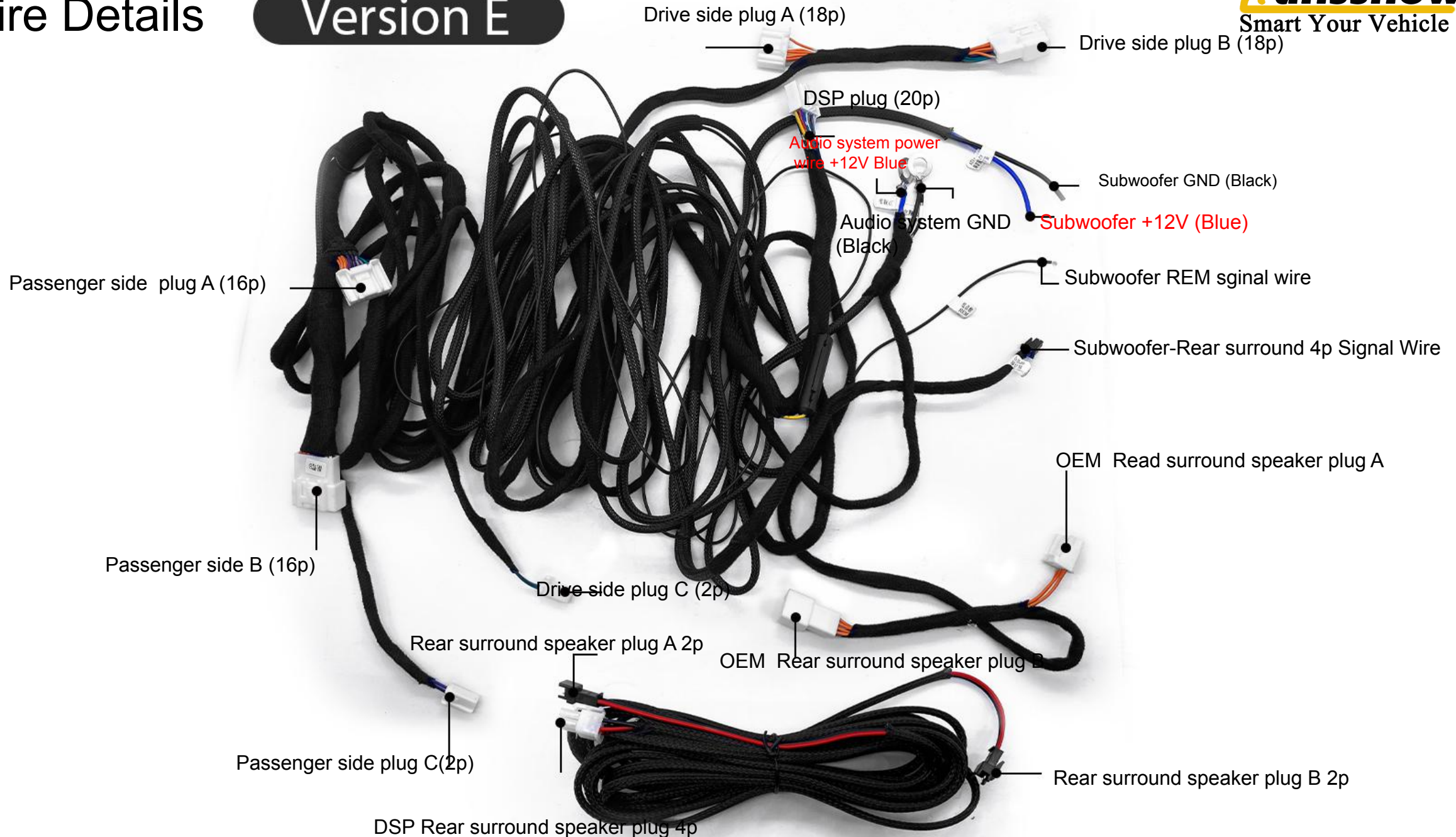

1. Front right seat area installation diagram



Installation diagram of the original Amp plug

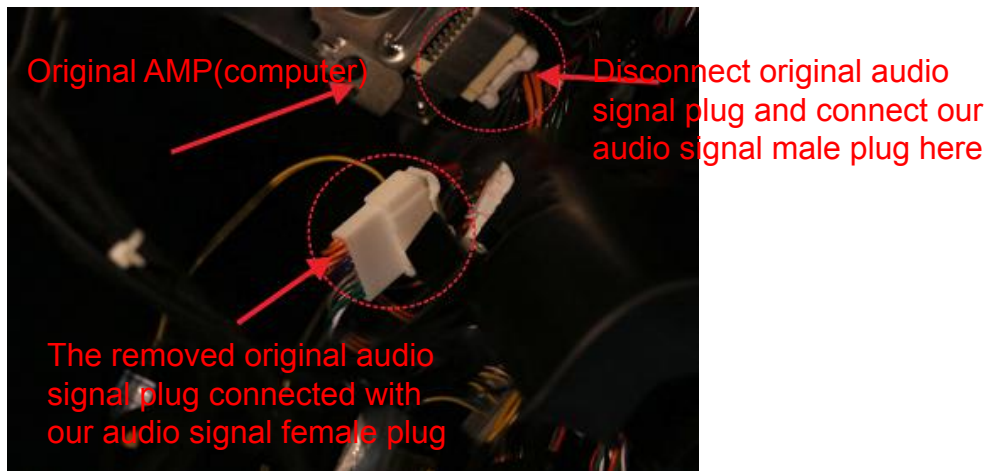

2.Front left side installation diagram



The male and female sockets are the same external for the driver and passenger, but the internal structure is different.

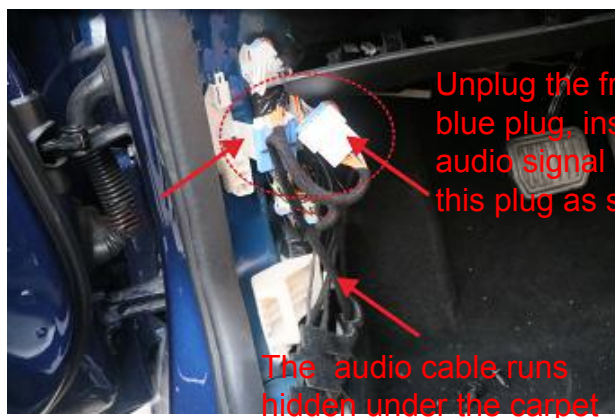
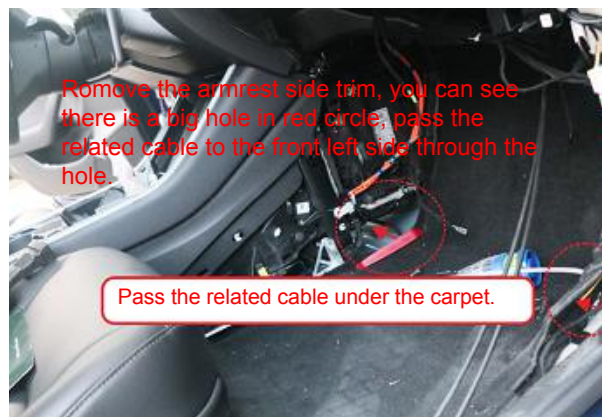

New added audio plug

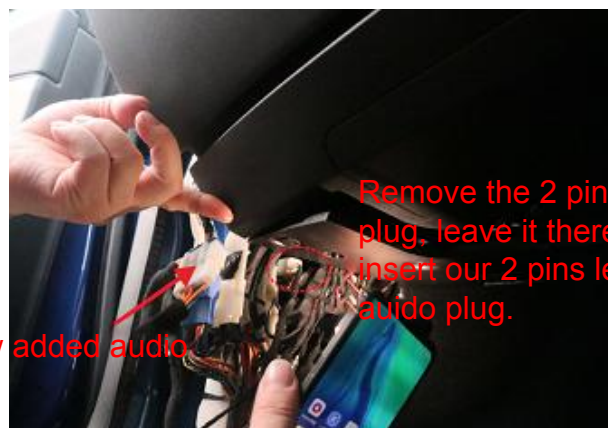

3.Front right seat DSP installation diagram

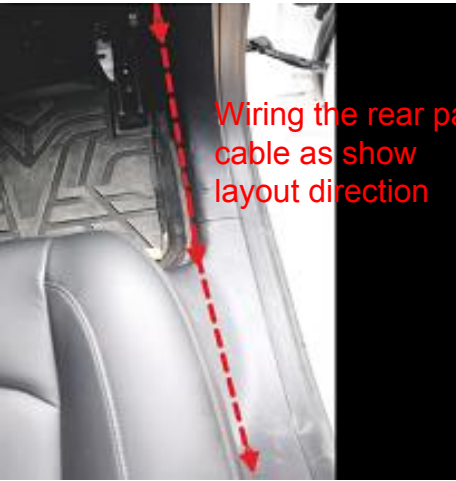
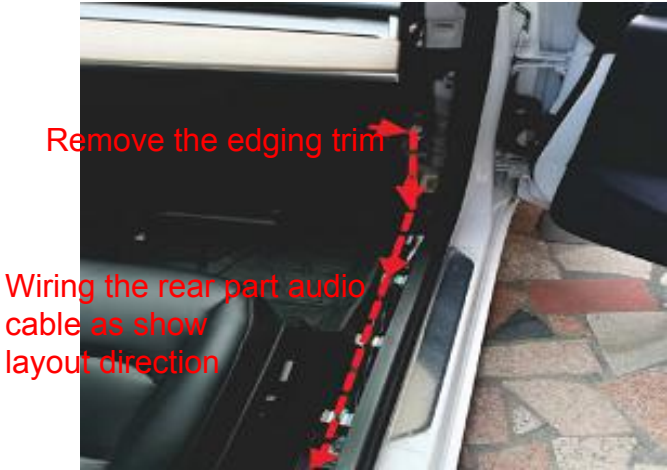

Front right side seat



4. Right rear power and rear surround wiring diagram

Power cable diagram

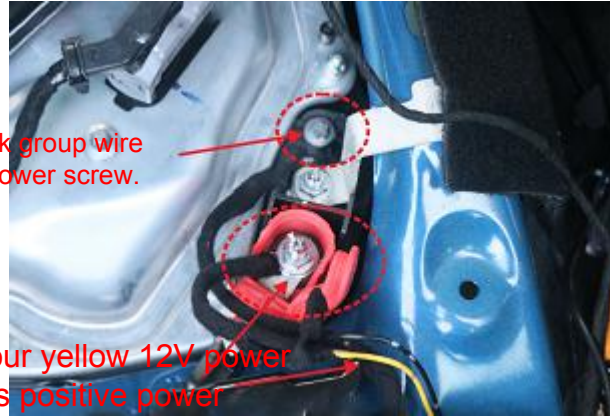

Connect our black group wire to this negative power screw.

Connect our yellow 12V power wire to this positive power screw.

Remove this trim and open the rear seat. You will see power wire under the rear seat.



Route the rear surround speakers cable from the arrow position

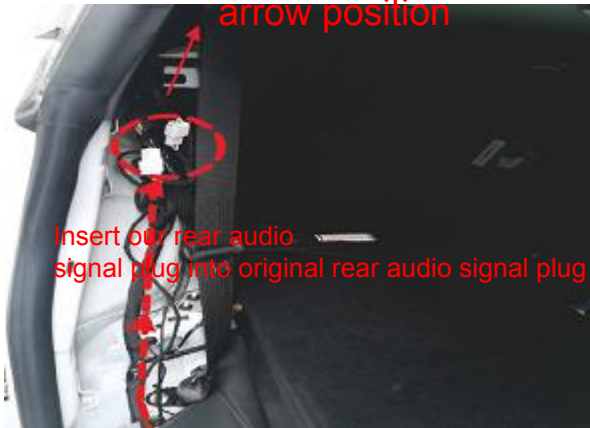

Insert our rear audio signal plug into original rear audio signal plug

Remove the rear trim, you will see there are 2 concave planes for rear speakers,

Adjust the rear speaker position so that you can fit the rear trim speaker net, cover the rear trim back do the adjustment.

Put the black audio glue at the bottom of the rear speaker after you confirmed the fit position. Push and whirling the speaker on the planes with glue to make it fixed well.

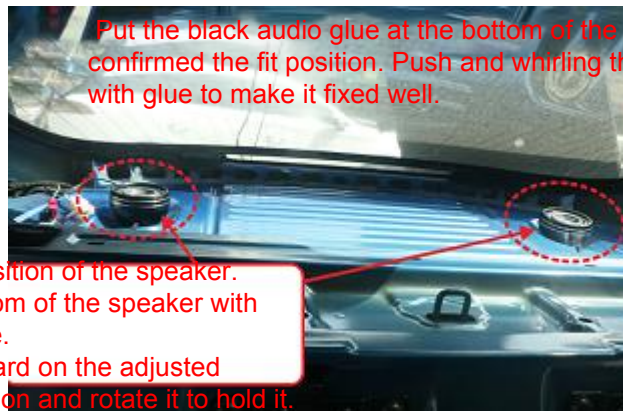

Adjust the position of the speaker. Glue the bottom of the speaker with our black glue. Then press hard on the adjusted speaker position and rotate it to hold it.

5. Trunk right side Subwoofer installation diagram

Remove the original black plastic trim.

Fix the subwoofer here with the original 3 screws.



Connect the 3 subwoofer signal wire according to the cable function table. Just need to loose the screw and fix it. You must connect the correct signal wire, or system can not work.

The signal cable plugs into the subwoofer signal adaptor.

Subwoofer-Rear surround 4p adaptor



Black wire connect to GND port.

Single yellow wire connect to REM port.

Blue wire connect to +12V port.