

Wiper Blades (Adjust)



Correction code 17501700

FRT 0.15

NOTE: Unless otherwise explicitly stated in the procedure, the above correction code and FRT reflect all of the work required to perform this procedure, including the linked procedures. **Do not stack correction codes unless explicitly told to do so.**

NOTE: See [Flat Rate Times](#) to learn more about FRTs and how they are created. To provide feedback on FRT values, email LaborTimeFeedback@tesla.com.

NOTE: See [Personal Protection](#) to make sure wearing proper PPE when performing the below procedure.

- 1448466-00-A TOOL, WIPER ADJUSTMENT

Adjustment

1. Using the touchscreen, put the wipers in "Service Mode".
2. Clean the wiper blades and the windshield thoroughly with isopropyl alcohol wipes, or equivalent.
3. Spray the windshield with the washer jets.
4. Cycle the wipers on high speed, and then inspect the cleaning pattern of the wiper blades:
 - If no streaking nor chattering of the windshield is present, discontinue this procedure.
 - If streaking or chattering of the windshield is present, continue to the next step.
5. Remove the LH wiper blade. See [Wiper Blades \(Remove and Replace\)](#) .
6. Loosen the plate screw of the wiper adjustment tool, so that the measurement plate rotates freely.

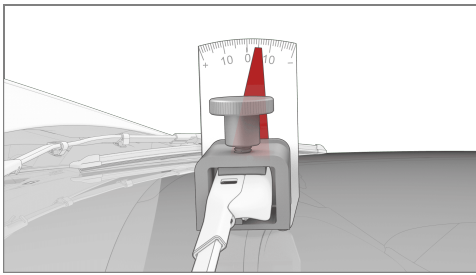

7. Loosen the thumbscrew on the tool, and slide the tool onto the end of the LH wiper arm.

8. Tighten the thumbscrew and make sure that both plastic points are resting on the windshield.

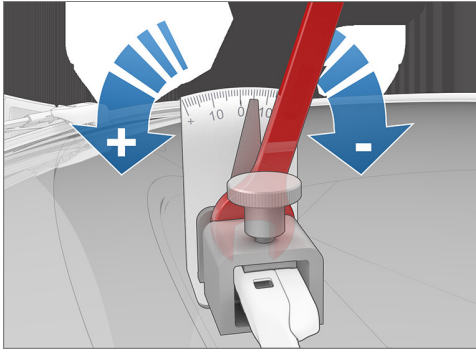

9. Check the wiper arm angle, and use a 24 mm wrench to rotate the tool as necessary to set the correct angle. **Adjust the wiper arm angle to -4 (+/- 0.5).**

10. Remove the tool from the wiper arm.

11. Install the wiper blade. See [Wiper Blades \(Remove and Replace\)](#) ○.

12. Repeat step 5 ○ to step 11 ○ for the RH wiper arm.

13. Using the touchscreen, remove the wipers from "Service Mode".

14. Spray the windshield with the washer jets and verify operation. If streaking or chattering still persists, replace the wiper blades and repeat this procedure.